

# CANAVERAL HARBOR BREVARD COUNTY, FLORIDA 4Q PORT HYDRO EXAM SURVEY FY21

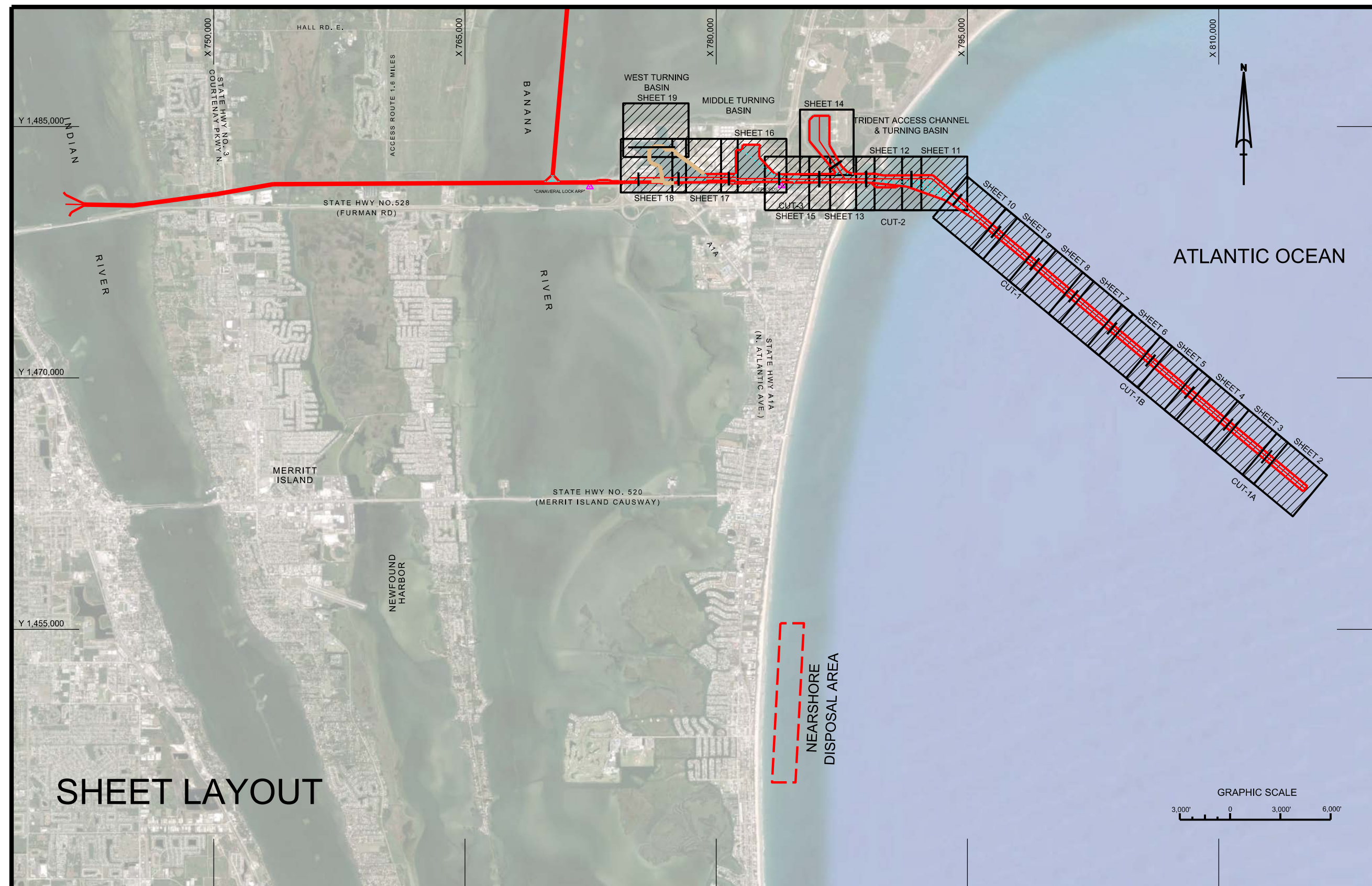
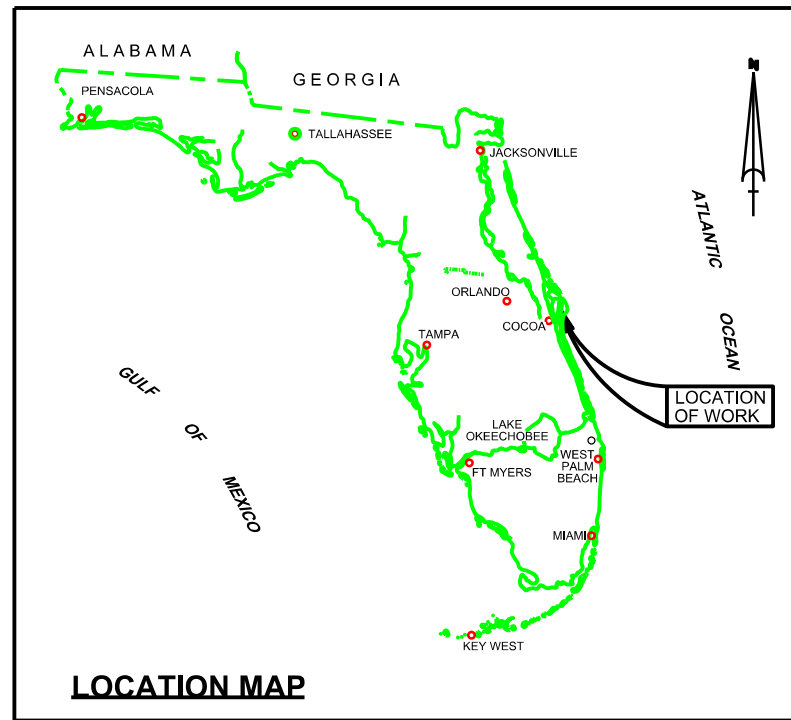

**SURVEY NOTES**

1. REFER TO SURVEY NO. 21-246.
  2. TIDAL REDUCTIONS WERE OBTAINED UTILIZING A REAL-TIME KINEMATIC (RTK) GPS AND REFERENCED TO MLLW UTILIZING A HYPACK KINEMATIC TIDE DATUM (KTD) MODEL. KTD FILE NAME IS: "CANAVERALHBR-2015 02 20.KTD".
  3. ALL ELEVATIONS ARE BELOW THE CHART DATUM UNLESS PRECEDED BY A (+) SIGN.
  4. PLANE COORDINATES ARE BASED ON THE TRANSVERSE MERCATOR PROJECTION FOR THE EAST ZONE OF FLORIDA AND REFERENCED TO THE CURRENT REALIZATION OF THE NORTH AMERICAN DATUM OF 1983 (NAD83), BASED ON THE NOAA NATIONAL SPATIAL REFERENCE SYSTEM (NSRS).
  5. ALL STATIONING REFERS TO THE CENTERLINE OF THE CHANNEL.
  6. THIS SURVEY WAS PERFORMED USING REAL-TIME KINEMATIC (RTK) GPS POSITIONING WITH THE FOLLOWING REFERENCE BASE LOCATION:  
 \*REFERENCE BASE LOCATED AT "CANAVERAL LOCK ARP" (PID: BBCV67)  
 \*TIDE STAFF LOCATED FROM "JEFFORDS" (PID: BBCQ55)
  7. DEPTHS DEPICTED BY THIS SURVEY ARE REFERENCED TO MLLW, TIDAL EPOCH 1983-2001 AS REPORTED BY THE NATIONAL OCEANIC AND ATMOSPHERIC ADMINISTRATION (NOAA). A MODIFIED VERSION OF NOAA'S VDATUM MODEL WAS USED TO CALIBRATE TO THE PUBLISHED MLLW HEIGHTS OF THE BENCHMARKS BELOW:  
 NOAA TIDAL STATION 872-1604, TRIDENT PIER, CANAVERAL, FL (PID: BBCQ55)
  8. VERTICAL MEASUREMENTS WERE MADE USING A RESON T20P MULTI-BEAM SYSTEM, A R2 SONIC MODEL 2024 MULTI-BEAM AND A ROSS SMARTSOUNDER DUAL-FREQUENCY 28/200 KHZ SINGLE-BEAM TRANSDUCER OPERATING AT 28/200 KHZ. HIGH FREQUENCY SOUNDINGS ARE SHOWN FOR CUT-1A, WEST ACCESS CHANNEL AND THE WEST TURNING BASIN. LOW FREQUENCY SOUNDINGS SHOWN FOR CUTS 1, 1B, 2, 3, MTB, AND THE POSEIDON WHARF.
- | VESSEL        | DATE OF SURVEY | CUT                               |
|---------------|----------------|-----------------------------------|
| SV FLORIDA II | 01 SEP 2021    | CUT-1A                            |
| SV FLORIDA II | 02 SEP 2021    | CUT-1B                            |
| SV FLORIDA II | 08 SEP 2021    | CUT-1                             |
| SB-52         | 28 SEP 2021    | CUT-2                             |
| SB-52         | 29 SEP 2021    | CUT-2, CUT-3, MTB, POSEIDON WHARF |
| SB-52         | 30 SEP 2021    | WAC, WTB                          |
9. AIDS TO NAVIGATION WERE LOCATED DURING THIS SURVEY.
  10. THE INFORMATION DEPICTED ON THIS MAP REPRESENTS THE RESULTS OF SURVEYS MADE ON THE DATES INDICATED ABOVE AND CAN ONLY BE CONSIDERED AS INDICATING THE GENERAL CONDITIONS AT THAT TIME. THIS CHART IS SOLELY FOR THE DISTRIBUTION OF AVAILABLE DEPTHS AT THE TIME OF THE SURVEY.
  11. SURVEY ACCURACY PERFORMANCE STANDARDS, QUALITY CONTROL AND QUALITY ASSURANCE REQUIREMENTS WERE FOLLOWED DURING THIS SURVEY IN ACCORDANCE WITH USACE EM 1110-2-1003, HYDROGRAPHIC SURVEYING, 30 NOV 2013.

LEGEND	
	MONUMENT
	LIGHTED BEACON
	GREEN DAYBEACON
	RED DAYBEACON
	RED LIGHTED BUOY
	GREEN LIGHTED BUOY
	CAN BUOY
	NUN BUOY
	TIDE STAFF
	PROJECT DEPTH

DEPARTMENT OF THE ARMY  
 JACKSONVILLE DISTRICT, CORPS OF ENGINEERS  
 JACKSONVILLE, FLORIDA

21-246-01-01-01-01-01 CANAVERAL HARBOR-CANAVARAL CHALAYOUTS/DGN	21-246-01-01-01-01-01 CANAVERAL HARBOR-CANAVARAL CHALAYOUTS/DGN	21-246-01-01-01-01-01 CANAVERAL HARBOR-CANAVARAL CHALAYOUTS/DGN	21-246-01-01-01-01-01 CANAVERAL HARBOR-CANAVARAL CHALAYOUTS/DGN
---	---	---	---

**4Q PORT HYDRO EXAM SURVEY FY21**  
 35, 39, 41, 43, 44 AND 46-FOOT PROJECT  
 INDEX, LOCATION AND VICINITY  
 PLAN

Scale: AS SHOWN  
 Drawing no.  
**1 / 18**  
 SHEET 1 OF 19

Project information table with columns for Name, Title, Date, and Organization. Includes project name and sheet number.

Grid coordinates X 813,500 through X 816,000 at the top of the sheet.

Grid coordinates Y 1,485,000 through Y 1,486,500 on the left side of the sheet.

Grid coordinates 10 through 1 along the top edge.

Grid coordinates F through A along the right edge.

Grid coordinates 10 through 1 along the bottom edge.

Grid coordinates F through A along the left edge.

Grid coordinates 10 through 1 along the bottom edge.

Grid coordinates F through A along the left edge.

Grid coordinates 10 through 1 along the bottom edge.

Grid coordinates F through A along the left edge.

Grid coordinates 10 through 1 along the bottom edge.

Grid coordinates F through A along the left edge.

Grid coordinates 10 through 1 along the bottom edge.

Grid coordinates F through A along the left edge.

Grid coordinates 10 through 1 along the bottom edge.

Grid coordinates F through A along the left edge.

Grid coordinates 10 through 1 along the bottom edge.

Grid coordinates F through A along the left edge.

Grid coordinates 10 through 1 along the bottom edge.

Grid coordinates F through A along the left edge.

Grid coordinates 10 through 1 along the bottom edge.

Grid coordinates F through A along the left edge.

Grid coordinates 10 through 1 along the bottom edge.

Grid coordinates F through A along the left edge.

Grid coordinates 10 through 1 along the bottom edge.

Grid coordinates F through A along the left edge.

Grid coordinates 10 through 1 along the bottom edge.

Grid coordinates F through A along the left edge.

Grid coordinates 10 through 1 along the bottom edge.

Grid coordinates F through A along the left edge.

Grid coordinates 10 through 1 along the bottom edge.

Grid coordinates F through A along the left edge.

Grid coordinates 10 through 1 along the bottom edge.

Grid coordinates F through A along the left edge.

Grid coordinates 10 through 1 along the bottom edge.

MATCHLINE SHEET NO. 3 STA. 30+00

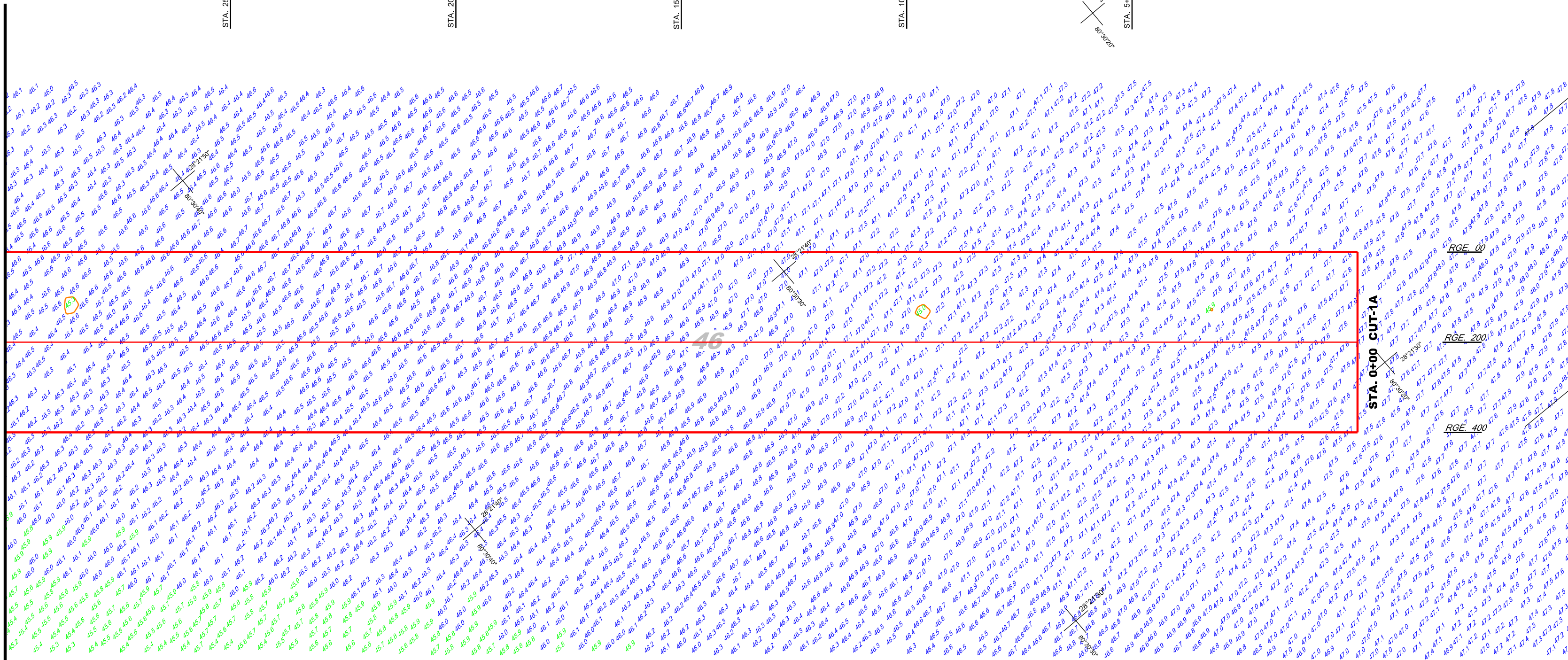

ATLANTIC OCEAN

CUT-1A

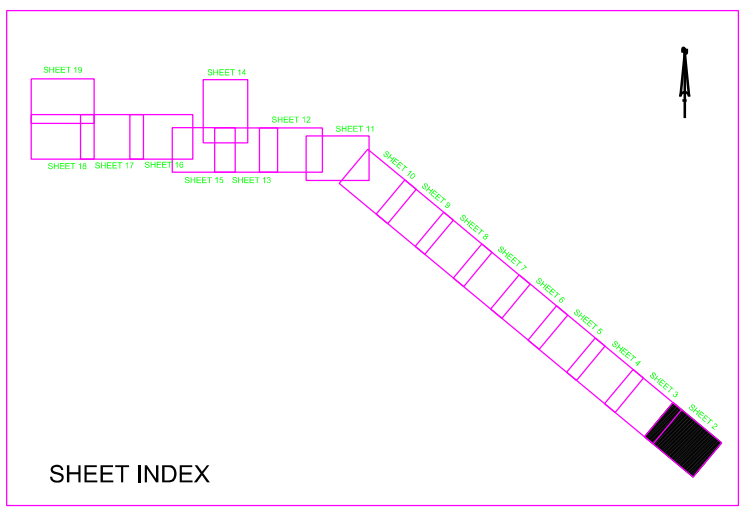

DEPTH COLOR CODE table:

≤41.9	[Red]
42.0-43.9	[Orange]
44.0-45.9	[Green]
≥46.0	[Blue]

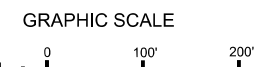
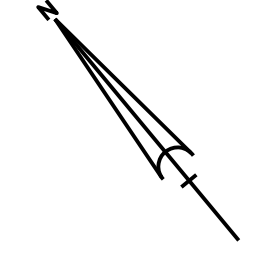

- NOTES:
- REFER TO SURVEY NO. 21-246.
  - SEE SHEET NO. 1 FOR SURVEY NOTES.
  - LAT/LONG GRID TICS ARE AT 10-SECOND INTERVALS.

21-246(4)-BIS-BRD/BLDN  
CANAVERAL HARBOR - CIVIL  
21-246(4)-S-0001.C1A.HF.DGN  
21-246(4)-V-CON46.DGN

4Q PORT HYDRO EXAM SURVEY FY21  
35, 39, 41, 43, 44 AND 46-FOOT PROJECT  
STA. 0+00 THRU 30+00 CUT - 1A  
PLAN



US Army Corps of Engineers  
Jacksonville District  
SAFETY ON THIS JOB  
DEPENDS ON YOU

ATLANTIC OCEAN

CUT-1A

MATCHLINE SHEET NO. 4 STA. 60+00

MATCHLINE SHEET NO. 2 STA. 30+00

RGE. 00

RGE. 200

RGE. 400

RGE. 00

RGE. 200

RGE. 400

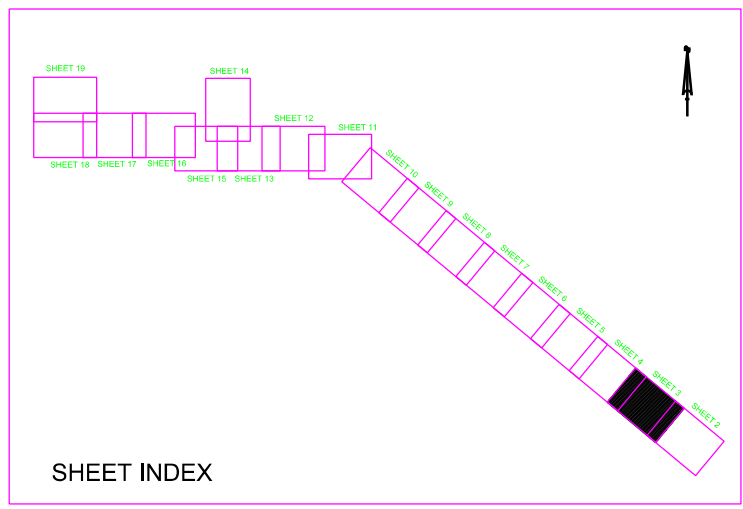
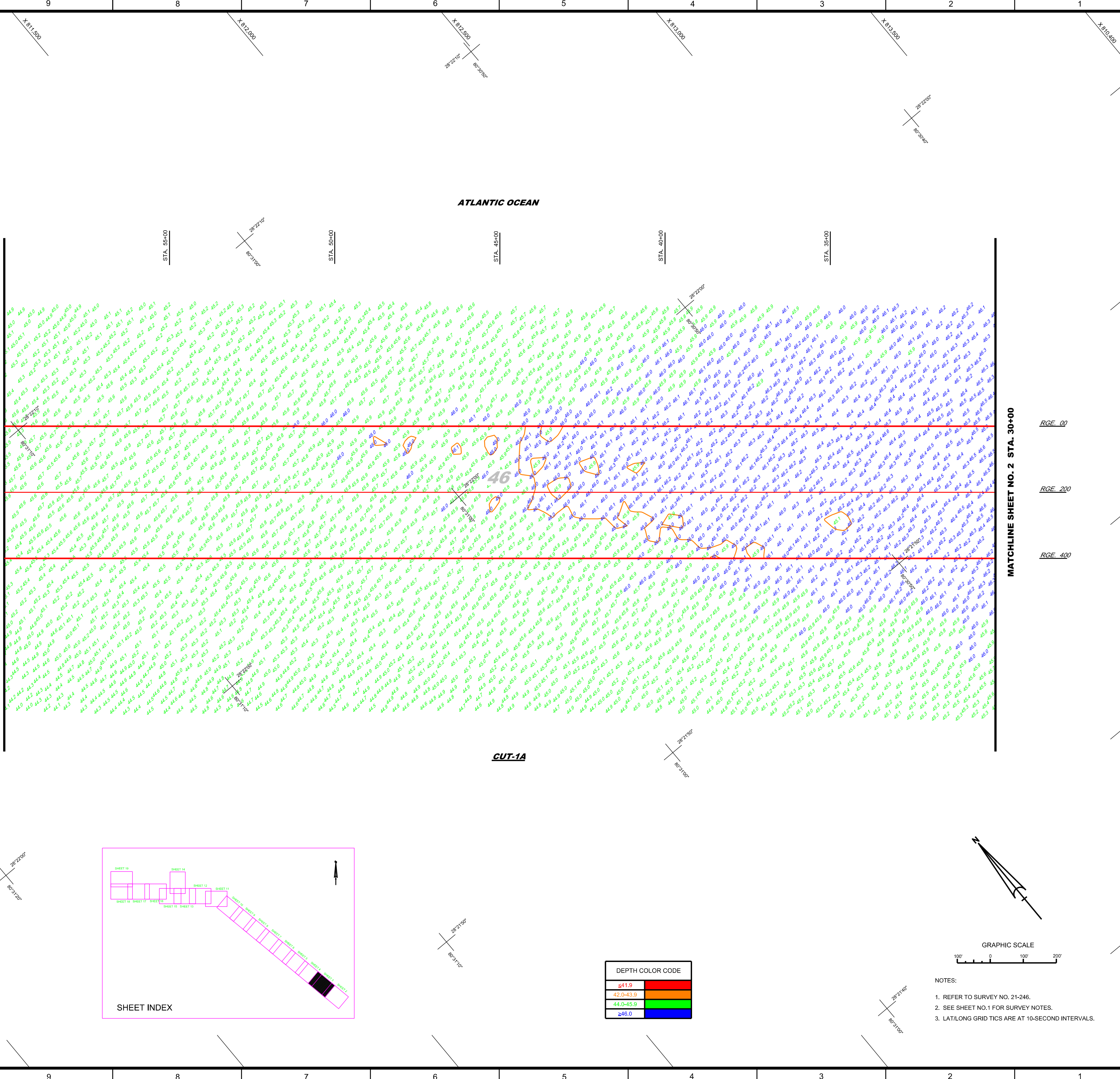

DEPTH COLOR CODE	
≤ 41.9	Red
42.0-43.9	Orange
44.0-45.9	Green
≥ 46.0	Blue

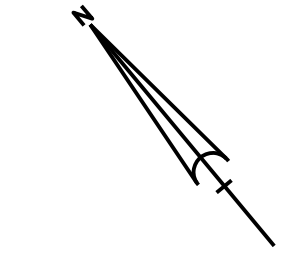

- NOTES:
- REFER TO SURVEY NO. 21-246.
  - SEE SHEET NO. 1 FOR SURVEY NOTES.
  - LAT/LONG GRID TICS ARE AT 10-SECOND INTERVALS.

Checked By: GHR  
Designed By: WRM  
Drawn By: WRM  
File Name: 21-246-AV-CON-046.DGN  
Date Plotted: SEP 2021

DEPARTMENT OF THE ARMY  
JACKSONVILLE DISTRICT, CORPS OF ENGINEERS  
JACKSONVILLE, FLORIDA

CANAVIAL HARBOR  
BREVARD COUNTY, FLORIDA  
**4Q PORT HYDRO EXAM SURVEY FY21**  
35, 39, 41, 43, 44 AND 46-FOOT PROJECT  
STA. 30+00 THRU 60+00 CUT - 1A  
**PLAN**

Scale: AS SHOWN  
Drawing no.  
**3 / 18**  
SHEET 3 OF 19

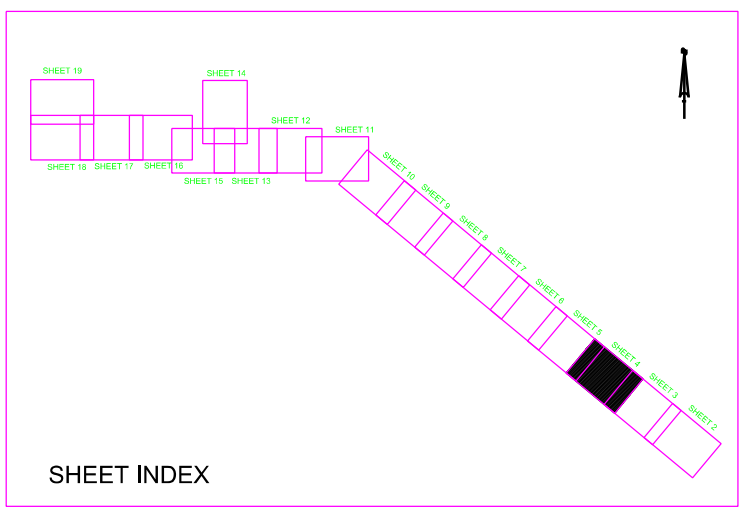
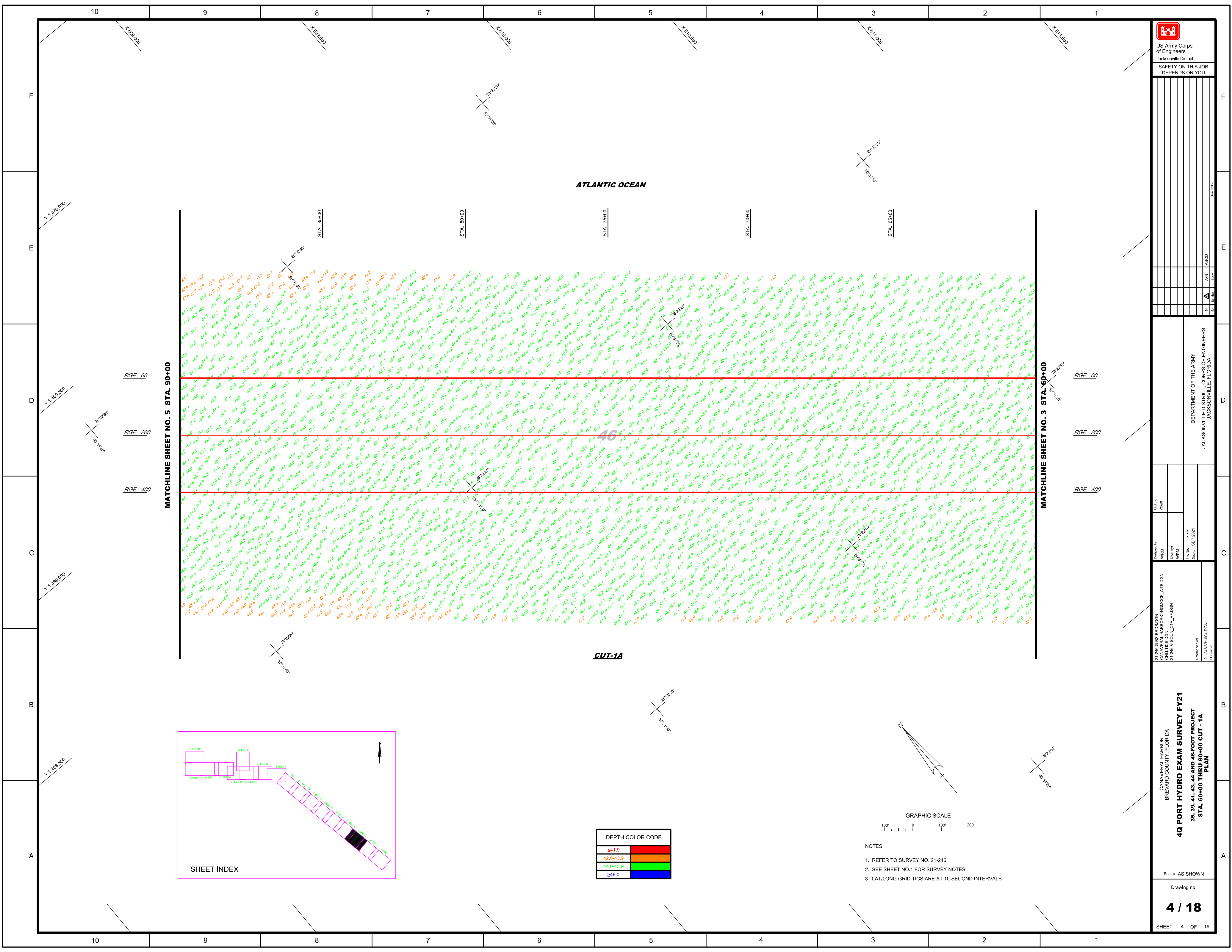

DEPTH COLOR CODE

≤41.9	Red
42.0-43.9	Orange
44.0-45.9	Yellow
≥46.0	Blue

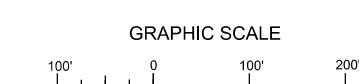

NOTES:  
1. REFER TO SURVEY NO. 21-246.  
2. SEE SHEET NO.1 FOR SURVEY NOTES.  
3. LAT/LONG GRID TICS ARE AT 10-SECOND INTERVALS.

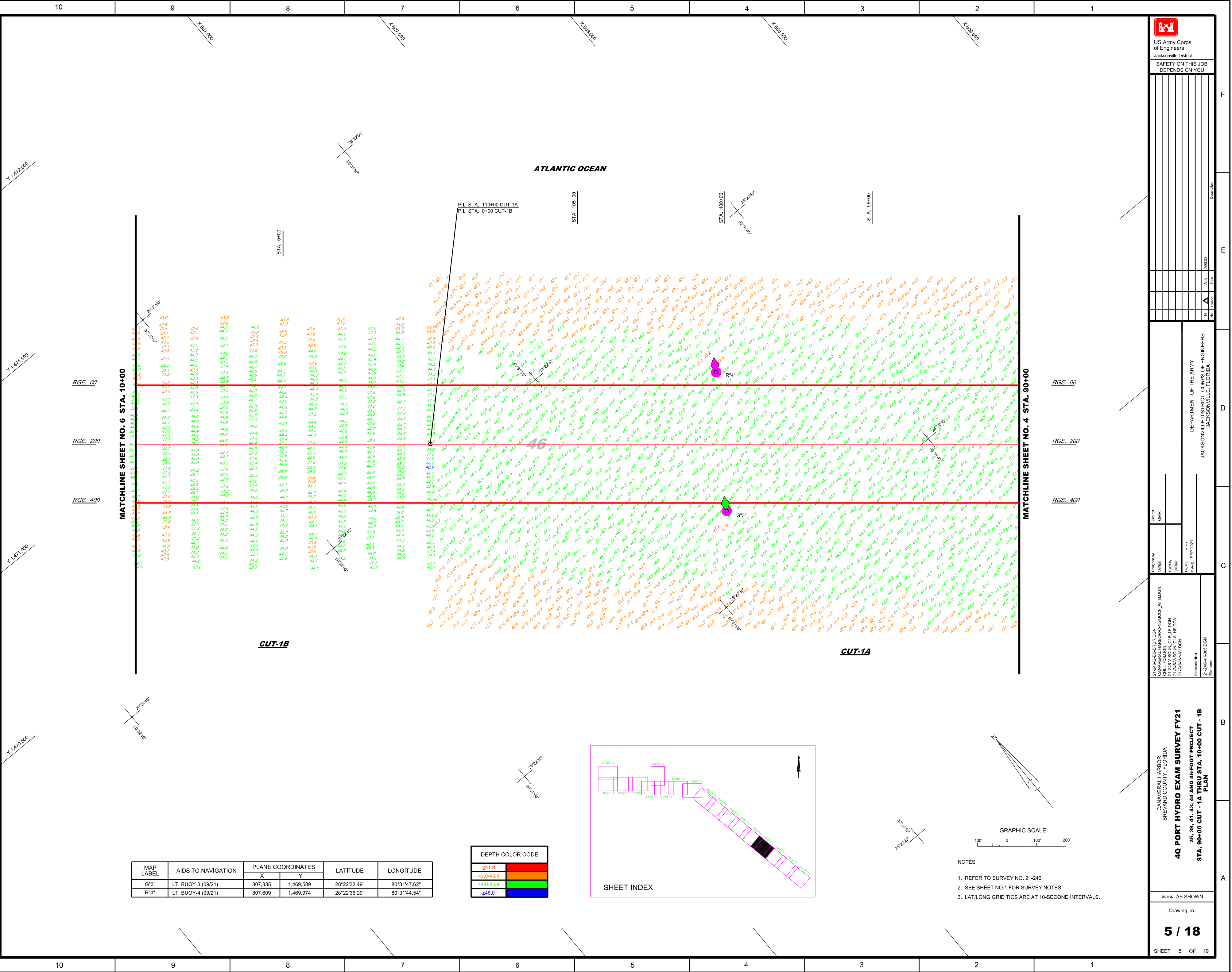

MAP LABEL	AIDS TO NAVIGATION	PLANE COORDINATES		LATITUDE	LONGITUDE
		X	Y		
G*3	LT. BUOY-3 (09/21)	807,335	1,469,589	28°22'32.49"	80°31'47.62"
R*4	LT. BUOY-4 (09/21)	807,609	1,469,974	28°22'36.29"	80°31'44.54"

DEPTH COLOR CODE	
≤41.9	Red
42.0-43.9	Orange
44.0-45.9	Green
≥46.0	Blue

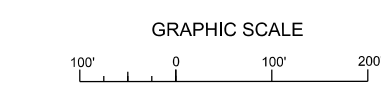
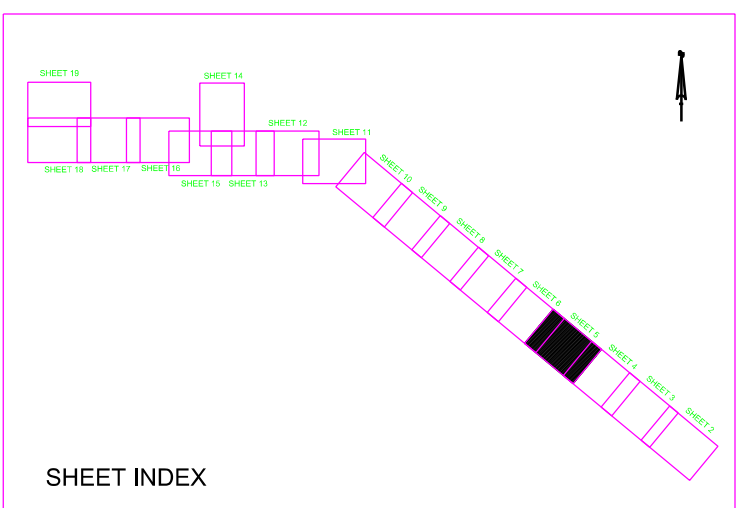

- NOTES:
1. REFER TO SURVEY NO. 21-246.
  2. SEE SHEET NO.1 FOR SURVEY NOTES.
  3. LAT/LONG GRID TICS ARE AT 10-SECOND INTERVALS.

Checked by: GHR	Designed by: WRM	21-246-C&S-BRD/BDN
Drawn by: WRM	21-246-A&S-SDN_C1B_LF.DGN	CANAVERAL HARBOR-C&S-NGMCCF_VTB.DGN
Scale: AS SHOWN	21-246-A&S-SDN_C1A_HF.DGN	BREVARD COUNTY, FLORIDA
Drawing no. <b>5 / 18</b>	21-246-A&S-SDN_C1A_HF.DGN	DEPARTMENT OF THE ARMY
	21-246-A&S-SDN_C1A_HF.DGN	JACKSONVILLE DISTRICT CORPS OF ENGINEERS
		JACKSONVILLE, FLORIDA

Scale: AS SHOWN

Drawing no. **5 / 18**

SHEET 5 OF 19

ATLANTIC OCEAN

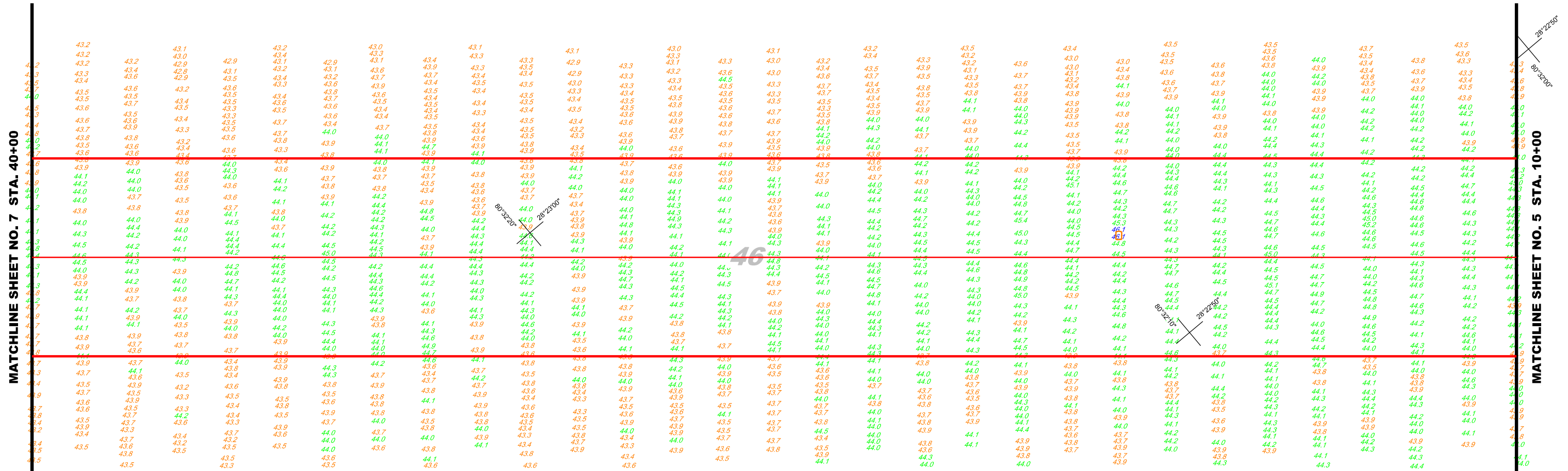

DEPTH COLOR CODE	
≤41.9	Red
42.0-43.9	Orange
44.0-45.9	Yellow
≥46.0	Blue

CUT-1B

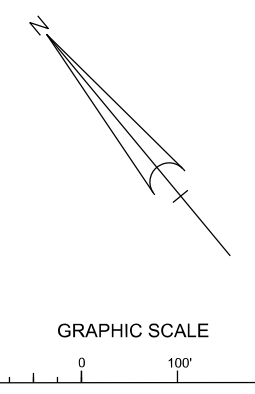
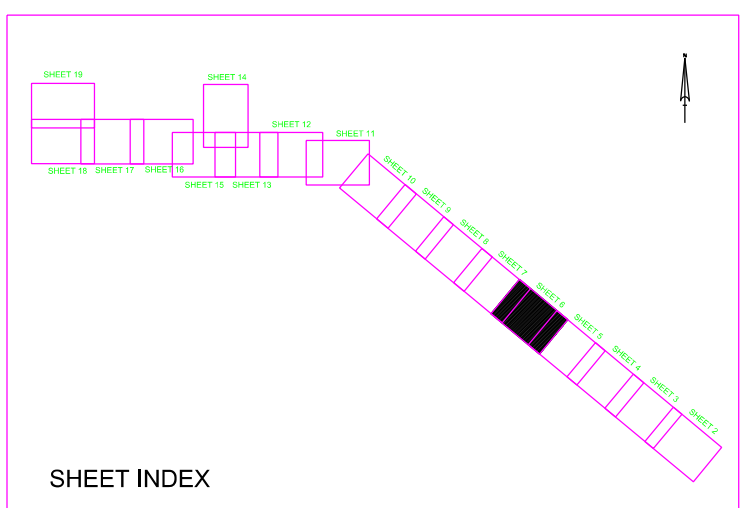

- NOTES:
- REFER TO SURVEY NO. 21-246.
  - SEE SHEET NO. 1 FOR SURVEY NOTES.
  - LAT/LONG GRID TICS ARE AT 10-SECOND INTERVALS.

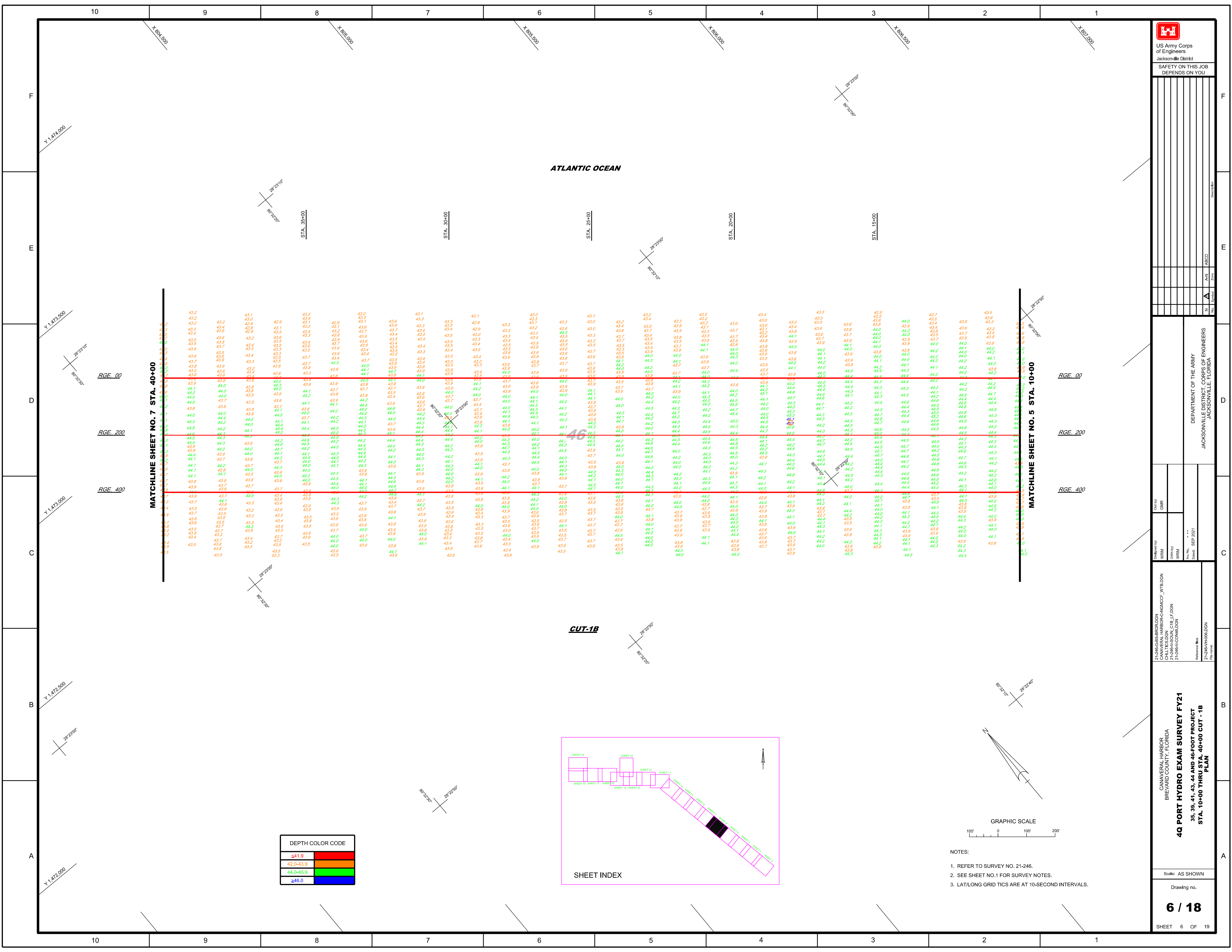



US Army Corps  
of Engineers  
Jacksonville District  
SAFETY ON THIS JOB  
DEPENDS ON YOU

Zone			
N	A	B	C
Scale			
1:50,000	1:25,000	1:10,000	1:5,000
Date			
2021	2021	2021	2021

DEPARTMENT OF THE ARMY  
JACKSONVILLE DISTRICT CORPS OF ENGINEERS  
JACKSONVILLE, FLORIDA

Checked by: GHR  
Designed by: WRM  
Drawn by: WRM  
Reviewed by: WRM  
Date: SEP 2021

21-246-35-HR07.DGN  
CANAVERAL HARBOR CHNGMCCP\_VTB.DGN  
21-246-35-0304\_C1\_F.DGN  
21-246-35-0304\_C1B\_F.DGN  
21-246-35-HW.DGN

CANAVERAL HARBOR  
BREVARD COUNTY, FLORIDA  
**4Q PORT HYDRO EXAM SURVEY FY21**  
35, 39, 41, 43, 44 AND 46-FOOT PROJECT  
STA. 40+00 CUT - 1B THRU STA. 15+00 CUT - 1

Scale: AS SHOWN  
Drawing no.

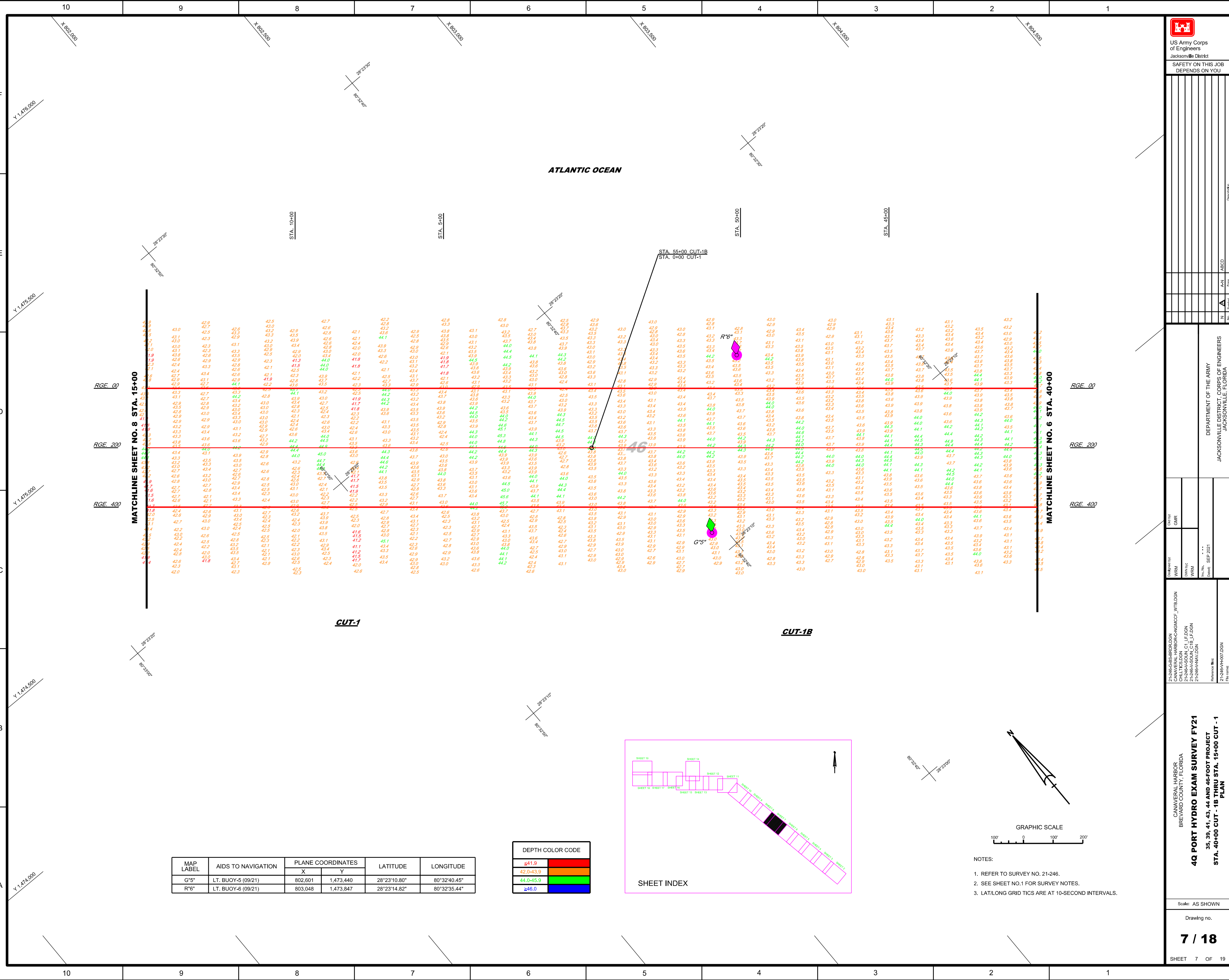

≤41.9	[Red]
42.0-43.9	[Orange]
44.0-45.9	[Yellow]
≥46.0	[Blue]

MAP LABEL	AIDS TO NAVIGATION	PLANE COORDINATES		LATITUDE	LONGITUDE
		X	Y		
G*5	LT. BUOY-5 (09/21)	802,601	1,473,440	28°23'10.80"	80°32'40.45"
R*6	LT. BUOY-6 (09/21)	803,048	1,473,847	28°23'14.82"	80°32'35.44"

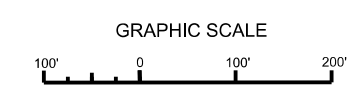
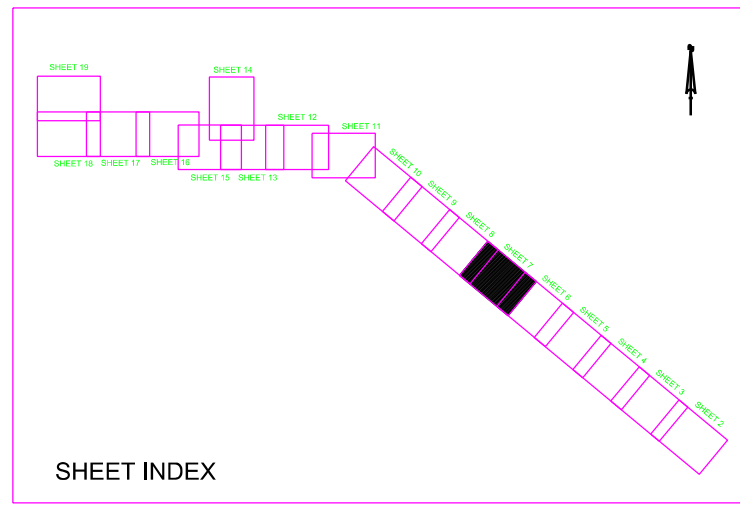

- NOTES:
- REFER TO SURVEY NO. 21-246.
  - SEE SHEET NO.1 FOR SURVEY NOTES.
  - LAT/LONG GRID TICS ARE AT 10-SECOND INTERVALS.

ATLANTIC OCEAN

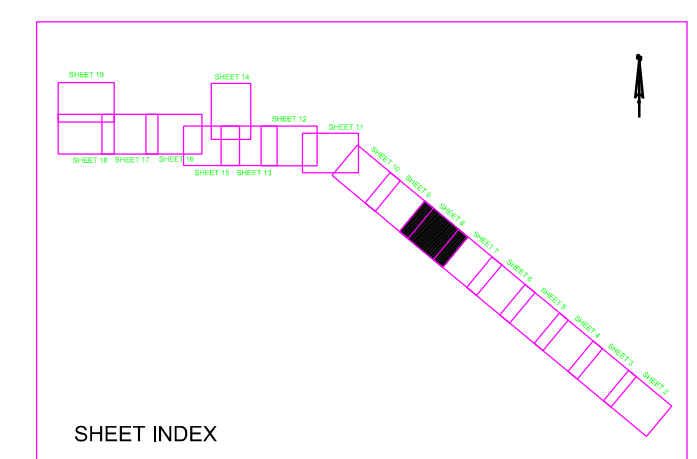
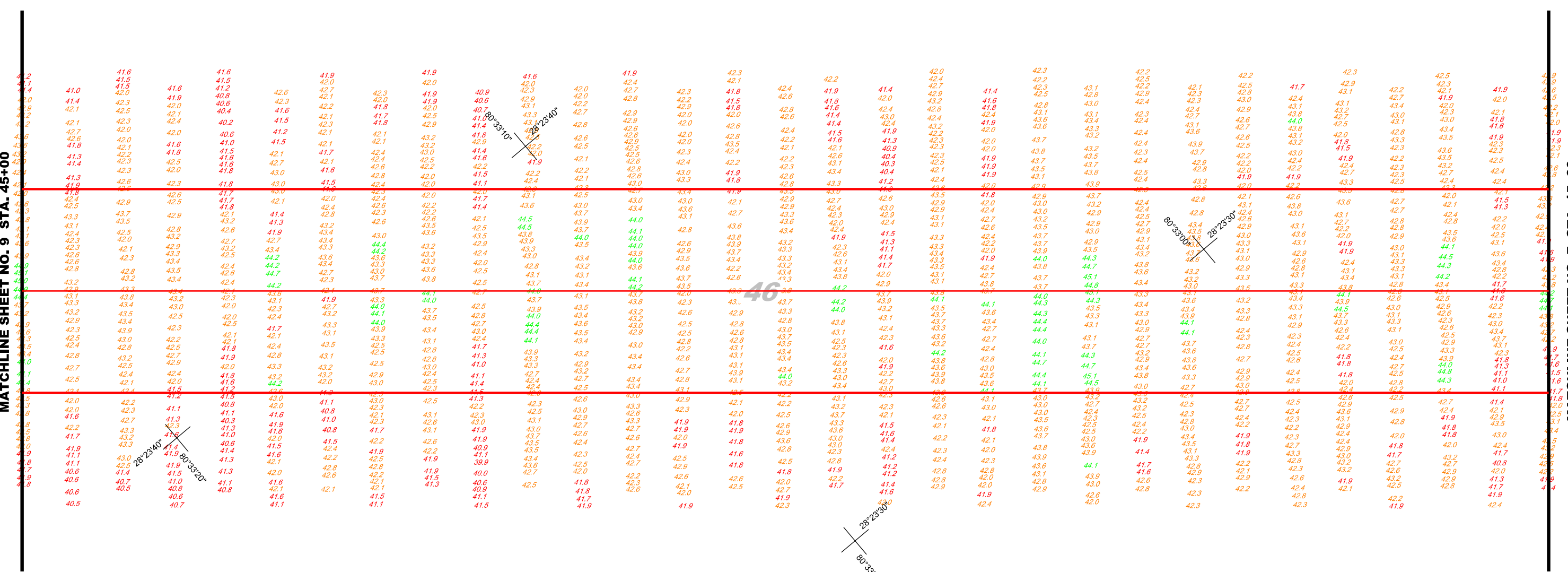

DEPTH COLOR CODE	
≤41.9	Red
42.0-43.9	Orange
44.0-45.9	Yellow
≥46.0	Blue

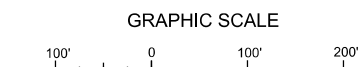

- NOTES:
1. REFER TO SURVEY NO. 21-246.
  2. SEE SHEET NO.1 FOR SURVEY NOTES.
  3. LAT/LONG GRID TICS ARE AT 10-SECOND INTERVALS.

21-246-C&S-HR04.DGN  
CANAVERAL HARBOR-C&S-INTCCT\_V17B.DGN  
21-246-A-SOUND\_CT\_L1.F.DGN

Checked by: GHR  
Designed by: WRM  
Drawn by: WRM  
Plot Date: 09/20/2021

CANAVERAL HARBOR  
BREVARD COUNTY, FLORIDA  
**4Q PORT HYDRO EXAM SURVEY FY21**  
35, 39, 41, 43, 44 AND 46-FOOT PROJECT  
STA. 15+00 THRU STA. 45+00 CUT - 1  
**PLAN**

DEPARTMENT OF THE ARMY  
JACKSONVILLE DISTRICT CORPS OF ENGINEERS  
JACKSONVILLE, FLORIDA



ATLANTIC OCEAN

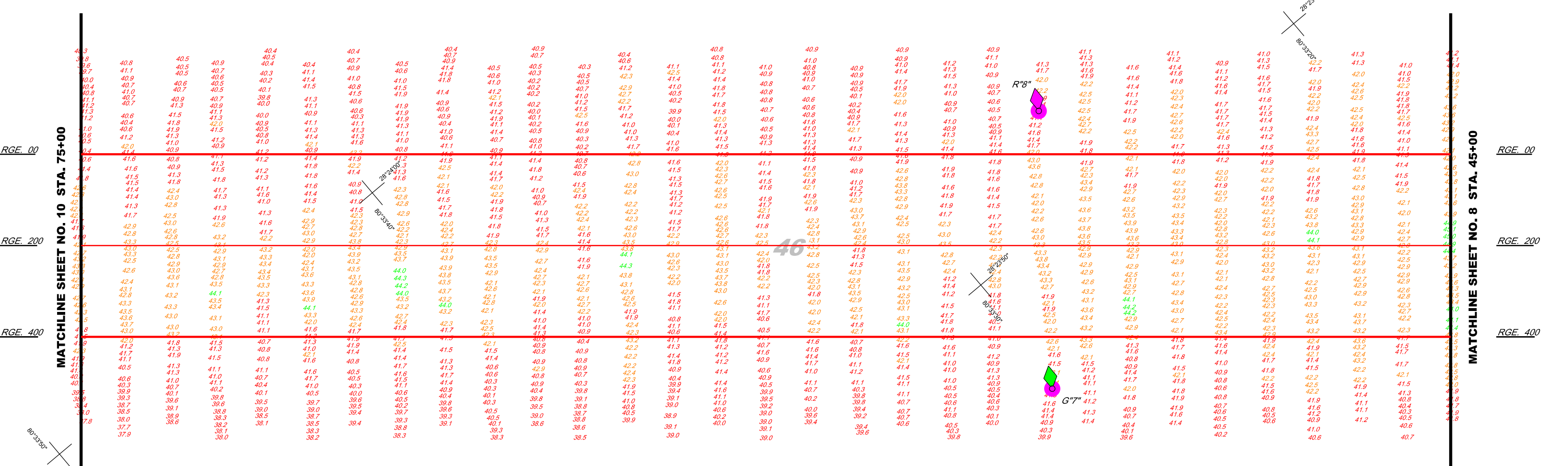

MAP LABEL	AIDS TO NAVIGATION	PLANE COORDINATES		LATITUDE	LONGITUDE
		X	Y		
G7"	LT. BUOY-7 (09/21)	798,138	1,477,108	28°23'47.28"	80°33'30.27"
R8"	LT. BUOY-8 (09/21)	798,504	1,477,595	28°23'52.09"	80°33'26.16"

DEPTH COLOR CODE	
≤41.9	Red
42.0-43.9	Orange
44.0-45.9	Yellow
≥46.0	Blue

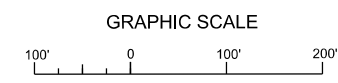
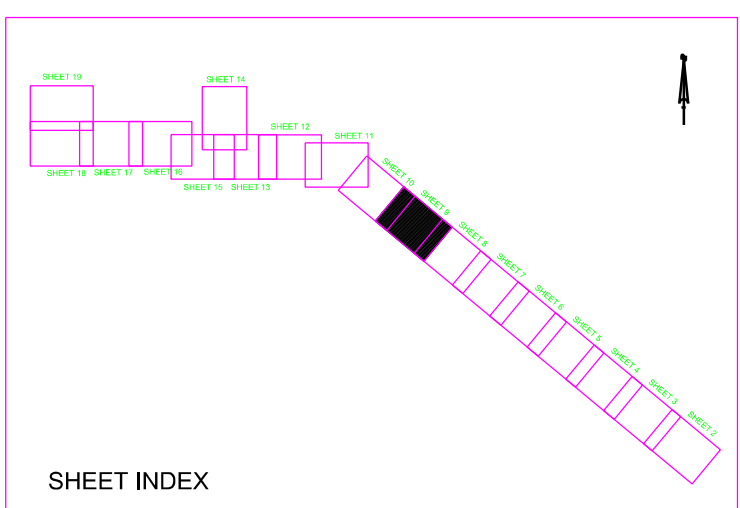

- NOTES:
- REFER TO SURVEY NO. 21-246.
  - SEE SHEET NO.1 FOR SURVEY NOTES.
  - LAT/LONG GRID TICS ARE AT 10-SECOND INTERVALS.

Zone	Grid	Symbol	Notes
N	A	[Symbol]	[Notes]
	B		
E	A	[Symbol]	[Notes]
	B		
D	A	[Symbol]	[Notes]
	B		
C	A	[Symbol]	[Notes]
	B		
B	A	[Symbol]	[Notes]
	B		
A	A	[Symbol]	[Notes]
	B		

DEPARTMENT OF THE ARMY  
JACKSONVILLE DISTRICT CORPS OF ENGINEERS  
JACKSONVILLE, FLORIDA

Designed by:  
WRM  
Checked: SEP 2021

21246-C4S-BRD/LDGN  
CANAVERAL HARBOR-C4S-NGMCC\_VYB/DGN  
21246-A500U\_C1\_LF/DGN  
21246-A500U\_C1\_LF/DGN  
21246-A500U\_C1\_LF/DGN

Canaveral Harbor  
Brevard County, Florida  
**4Q PORT HYDRO EXAM SURVEY FY21**  
35, 39, 41, 43, 44 AND 46-FOOT PROJECT  
STA. 75+00 THRU STA. 105+00 CUT - 1  
PLAN

Scale: AS SHOWN  
Drawing no.  
**10 / 18**  
SHEET 10 OF 19

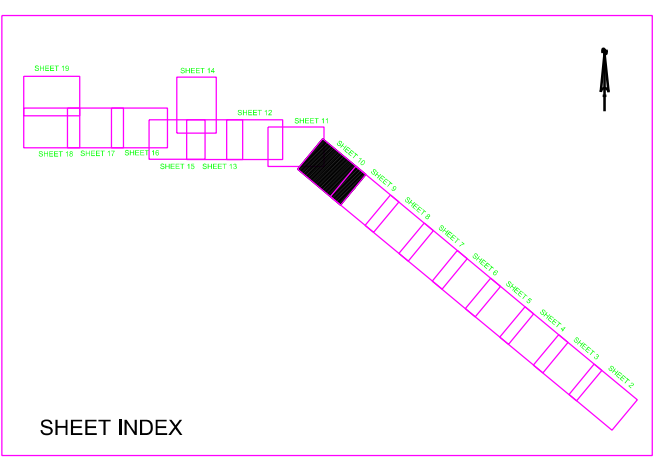
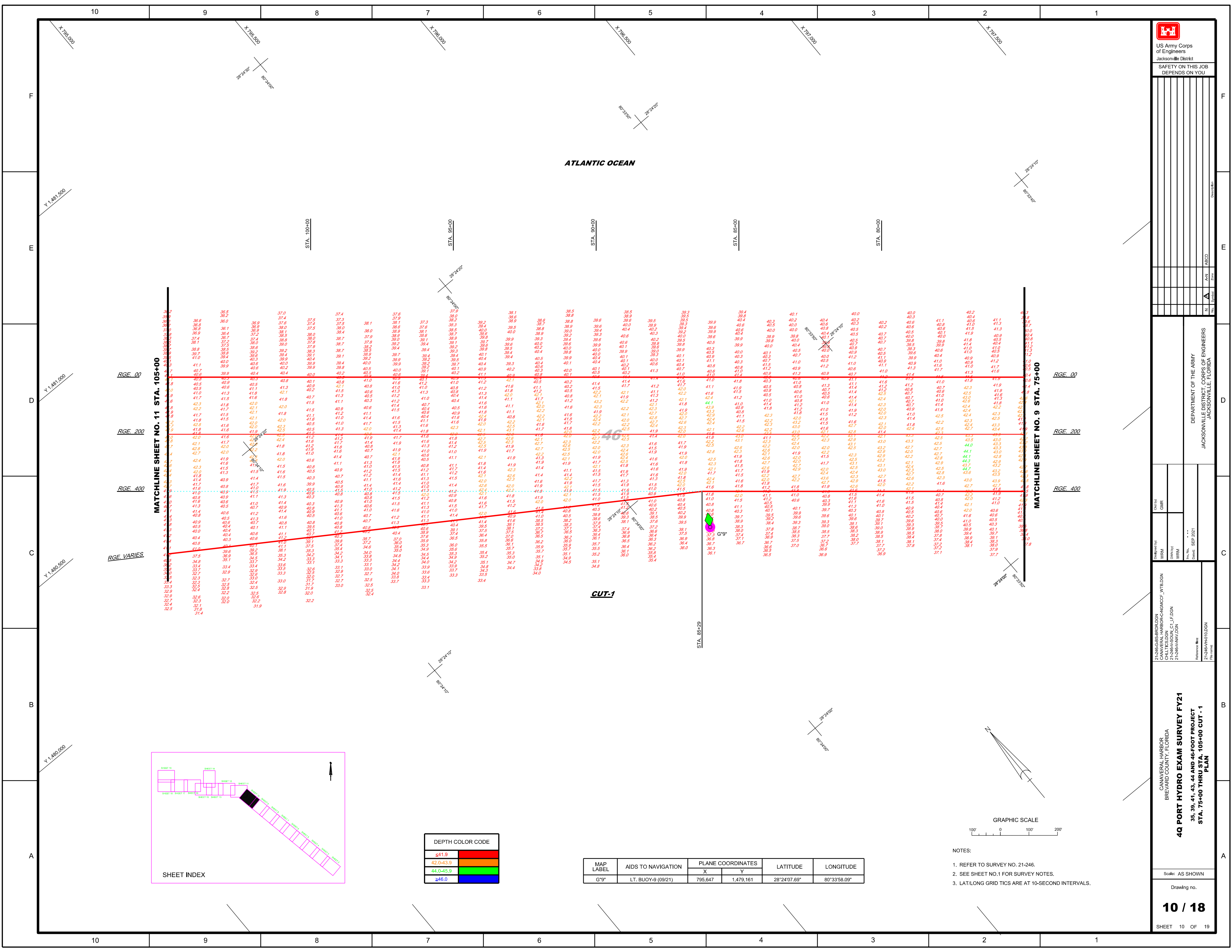

DEPTH COLOR CODE

≤41.9	[Red]
42.0-43.9	[Orange]
44.0-45.9	[Yellow]
≥46.0	[Blue]

MAP LABEL	AIDS TO NAVIGATION	PLANE COORDINATES		LATITUDE	LONGITUDE
		X	Y		
G-9"	LT. BUOY-9 (09/21)	795,647	1,479,161	28°24'07.69"	80°33'58.09"

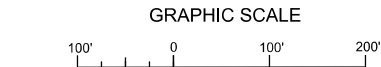

- NOTES:
- REFER TO SURVEY NO. 21-246.
  - SEE SHEET NO. 1 FOR SURVEY NOTES.
  - LAT/LONG GRID TICS ARE AT 10-SECOND INTERVALS.

MAP LABEL	AIDS TO NAVIGATION	PLANE COORDINATES		LATITUDE	LONGITUDE
		X	Y		
R*10"	LT. BUOY-10 (09/21)	792,861	1,482,105	28°24'36.95"	80°34'29.16"
G*11"	LT. BUOY-11 (09/21)	793,643	1,480,502	28°24'21.05"	80°34'20.47"

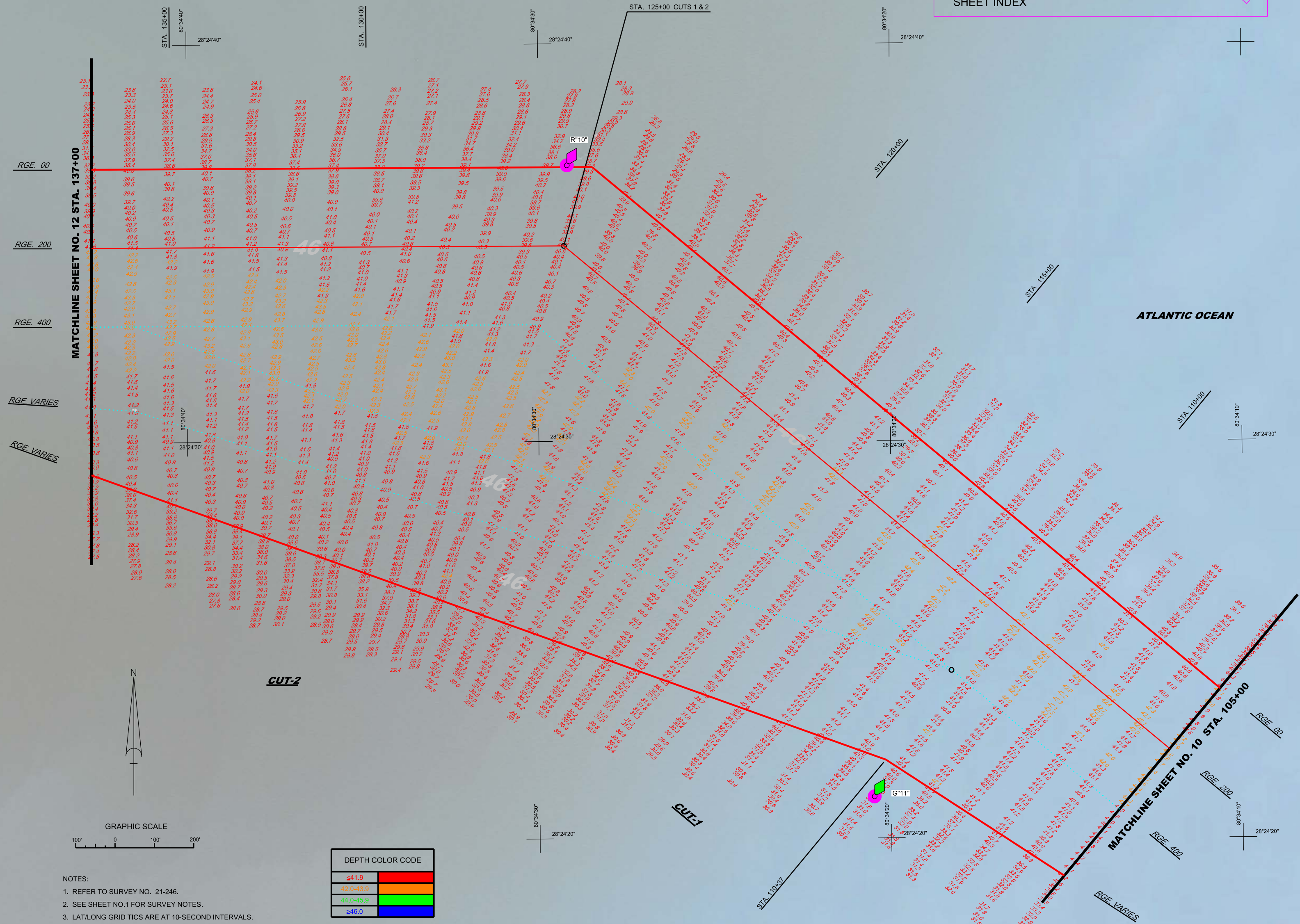
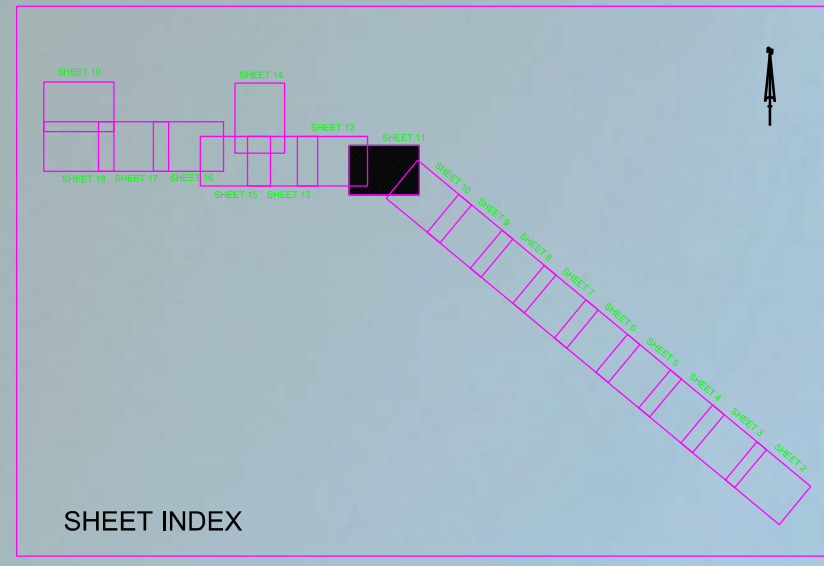

DEPTH COLOR CODE	
≤41.9	Red
42.0-43.9	Orange
44.0-45.9	Yellow
≥46.0	Blue

- NOTES:
- REFER TO SURVEY NO. 21-246.
  - SEE SHEET NO.1 FOR SURVEY NOTES.
  - LAT/LONG GRID TICS ARE AT 10-SECOND INTERVALS.

US Army Corps of Engineers  
Jacksonville District

SAFETY ON THIS JOB  
DEPENDS ON YOU

---

DEPARTMENT OF THE ARMY  
JACKSONVILLE DISTRICT CORPS OF ENGINEERS  
JACKSONVILLE, FLORIDA

---

21-246-CHS-BRDLDGN  
CANAVERAL HARBOR-CNGMCCF\_VTB.DGN  
21-246-AS-SOUN\_CL\_LF.DGN  
21-246-AS-SOUN\_CO\_LF.DGN  
21-246-AS-HANV.DGN

Designed by: WRM  
Checked by: WRM  
Date: SEP 2021

---

Scale: AS SHOWN

Drawing no.

**11 / 18**

SHEET 11 OF 19

US Army Corps of Engineers  
Jacksonville District

SAFETY ON THIS JOB  
DEPENDS ON YOU

DEPARTMENT OF THE ARMY  
JACKSONVILLE DISTRICT CORPS OF ENGINEERS  
JACKSONVILLE, FLORIDA

Drawn by: GHR  
Checked by: WRM  
Scale: AS SHOWN

21-246-GS-IBR/BLDGN  
CANAVERAL HARBOR-C&G-MICC-FYB/DGN  
21-189A-SOUL-CZ-LF/DGN  
21-189A-COM-6/DGN  
21-189A-IBR/BLDGN

4Q PORT HYDRO EXAM SURVEY FY21  
35, 39, 41, 43, 44 AND 46-FOOT PROJECT  
STA. 137+00 THRU STA. 164+00 CUT - 2  
PLAN

Scale: AS SHOWN  
Drawing no.  
**12 / 18**  
SHEET 12 OF 19

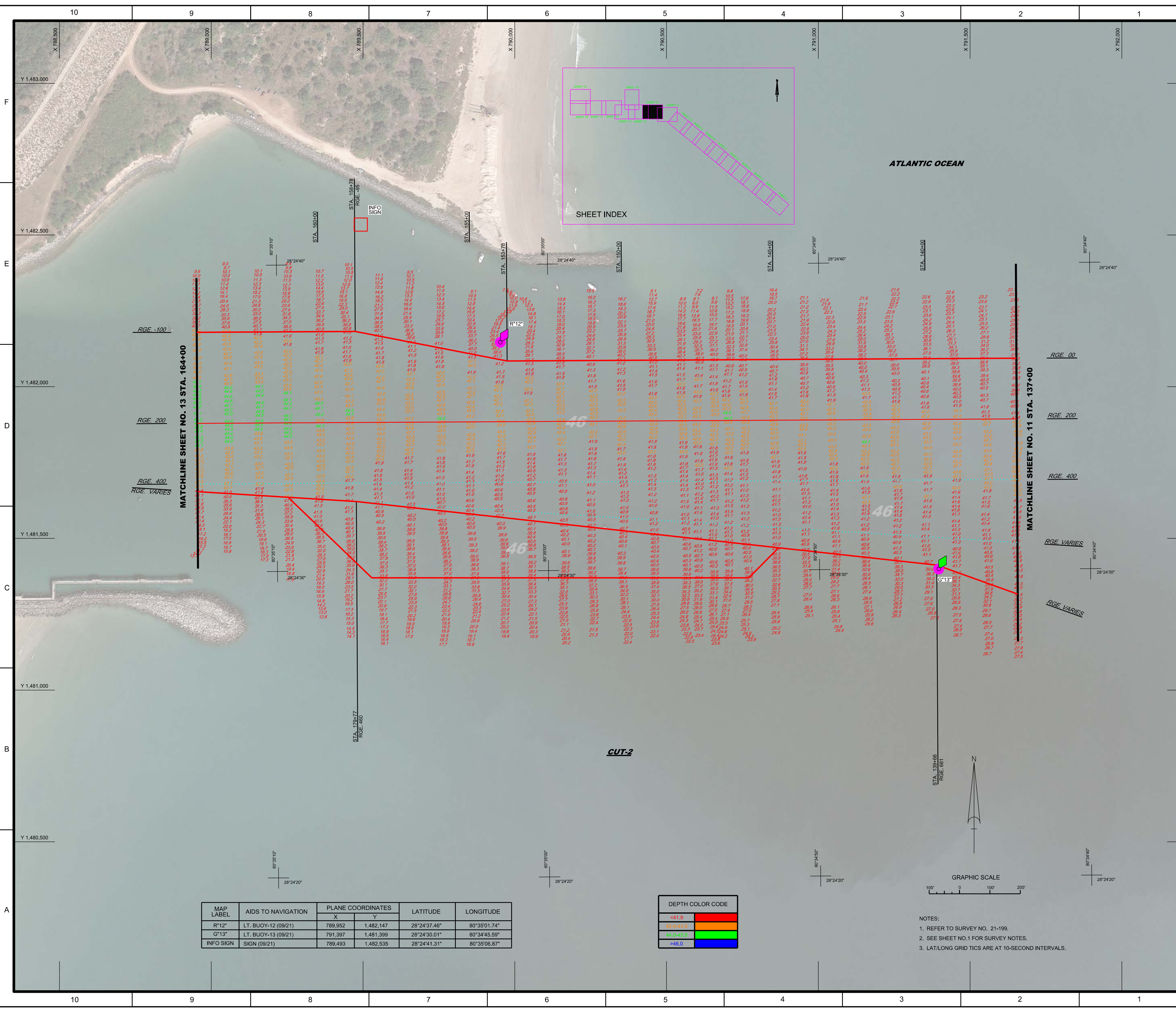

MAP LABEL	AIDS TO NAVIGATION	PLANE COORDINATES		LATITUDE	LONGITUDE
		X	Y		
R"12"	LT. BUOY-12 (09/21)	789,952	1,482,147	28°24'37.46"	80°35'01.74"
G"13"	LT. BUOY-13 (09/21)	791,397	1,481,399	28°24'30.01"	80°34'45.59"
INFO SIGN	SIGN (09/21)	789,493	1,482,535	28°24'41.31"	80°35'06.87"

DEPTH COLOR CODE	
<41.9	Red
42.0-43.9	Orange
44.0-45.9	Yellow
>46.0	Green

NOTES:  
1. REFER TO SURVEY NO. 21-199.  
2. SEE SHEET NO.1 FOR SURVEY NOTES.  
3. LAT/LONG GRID TICS ARE AT 10-SECOND INTERVALS.

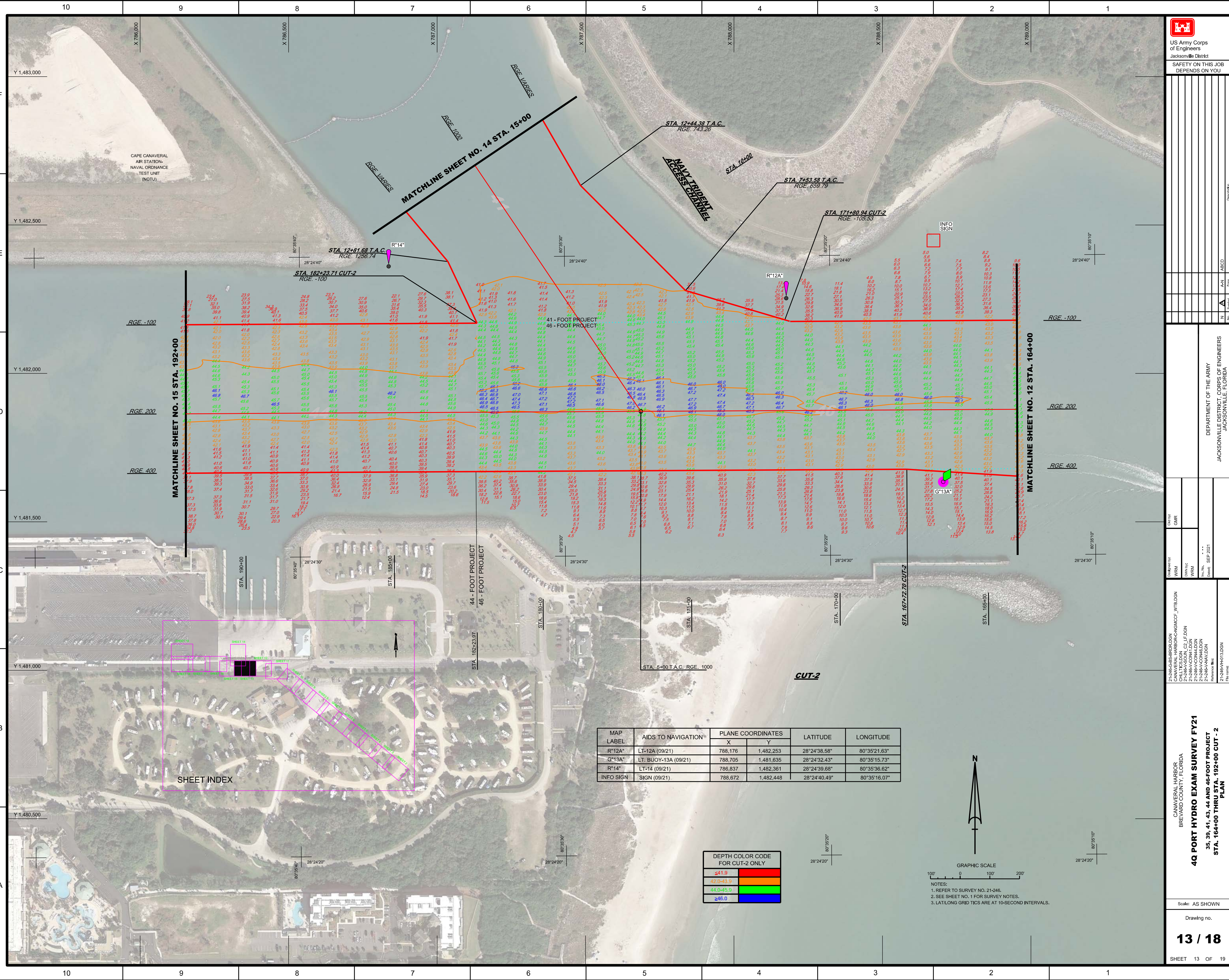

CAPE CANAVERAL  
AIR STATION-  
NAVAL ORDNANCE  
TEST UNIT  
(NOTU)

SHEET INDEX

MAP LABEL	AIDS TO NAVIGATION	PLANE COORDINATES		LATITUDE	LONGITUDE
		X	Y		
R*12A	LT-12A (09/21)	788,176	1,482,253	28°24'38.58"	80°35'21.63"
G*13A	LT. BUOY-13A (09/21)	788,705	1,481,635	28°24'32.43"	80°35'15.73"
R*14	LT-14 (09/21)	786,837	1,482,361	28°24'39.68"	80°35'36.62"
INFO SIGN	SIGN (09/21)	788,672	1,482,448	28°24'40.49"	80°35'16.07"

DEPTH COLOR CODE FOR CUT-2 ONLY

<41.9	Red
42.0-43.9	Orange
44.0-45.9	Yellow
>46.0	Blue

GRAPHIC SCALE  
100' 0 100' 200'  
NOTES:  
1. REFER TO SURVEY NO. 21-246.  
2. SEE SHEET NO. 1 FOR SURVEY NOTES.  
3. LAT/LONG GRID TICS ARE AT 10-SECOND INTERVALS.

21-246-GS-BRD/DGN  
CANAVARAL HARBOR-CNG/MCCP\_WTB/DGN  
21-246-A-SOUN\_C2\_LF/DGN  
21-246-A-COM1/DGN  
21-246-A-COM2/DGN  
21-246-A-NAV/DGN  
Reference: 21-246-PA1/DGN  
Date: SEP 2021  
Scale: AS SHOWN

CAANAVARAL HARBOR  
BREVARD COUNTY, FLORIDA  
**4Q PORT HYDRO EXAM SURVEY FY21**  
35, 39, 41, 43, 44 AND 46-FOOT PROJECT  
STA. 1644+00 THRU STA. 192+00 CUT - 2  
PLAN

DEPTH COLOR CODE FOR CUT-2 ONLY

<41.9	Red
42.0-43.9	Orange
44.0-45.9	Yellow
≥46.0	Blue

MAP LABEL	AIDS TO NAVIGATION	PLANE COORDINATES		LATITUDE	LONGITUDE
		X	Y		
R"14A"	LT. BUOY-14A (09/21)	783,934	1,482,190	28°24'38.09"	80°36'09.13"

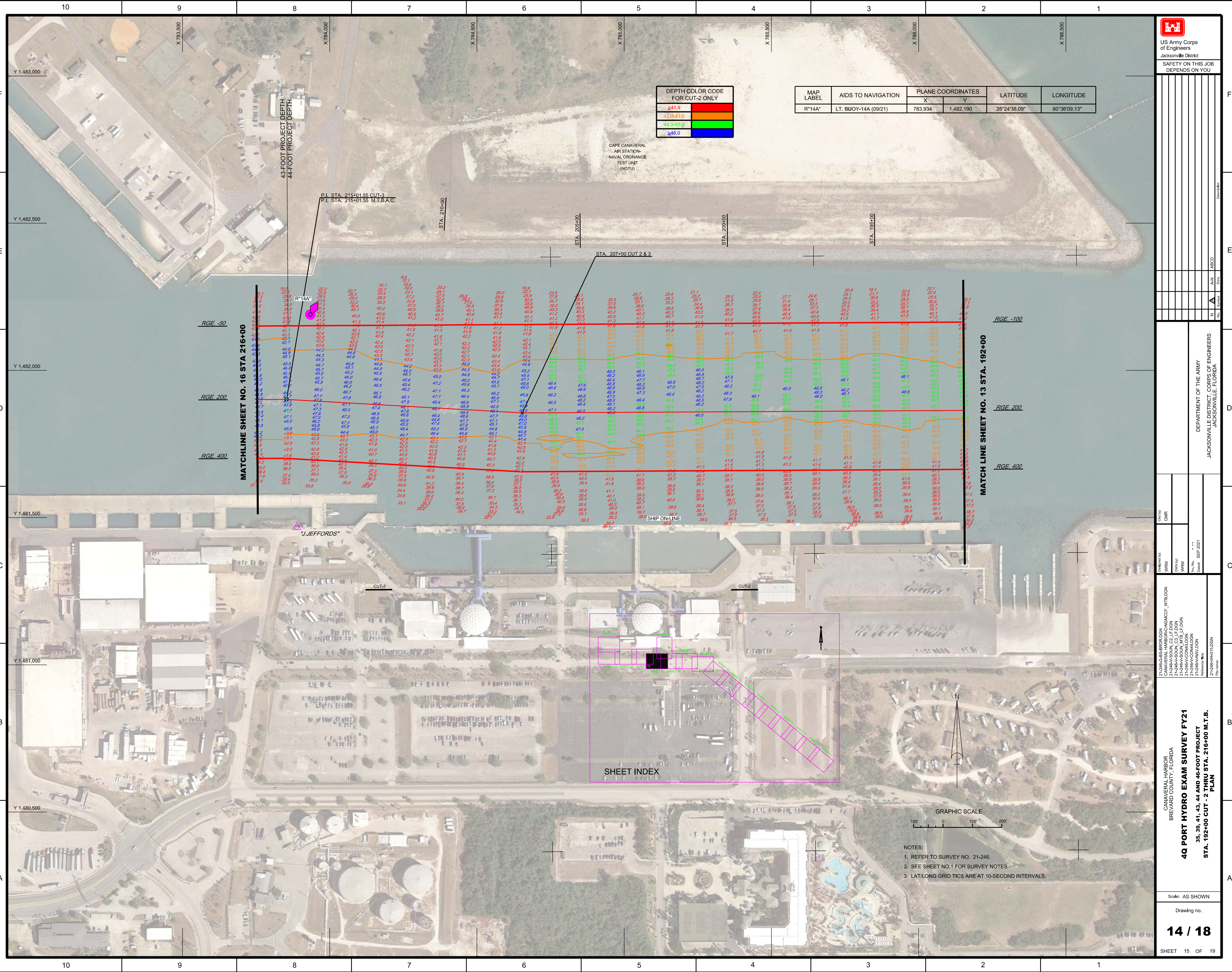

Zone	AN	ABCD	Zone
N	A	ABCD	N

DEPARTMENT OF THE ARMY  
JACKSONVILLE DISTRICT CORPS OF ENGINEERS  
JACKSONVILLE, FLORIDA

Checked by:	GHR
Designed by:	WRM
Drawn by:	WRM
File No.:	21-246-000
Contract:	SEP 2021

21-246-000-001.DGN  
CANAVERAL HARBOUR/CAIC/NOICCF\_WTB.DGN  
21-246-000-002.DGN  
21-246-000-003.DGN  
21-246-000-004.DGN  
21-246-000-005.DGN  
21-246-000-006.DGN  
21-246-000-007.DGN  
21-246-000-008.DGN  
21-246-000-009.DGN  
21-246-000-010.DGN  
21-246-000-011.DGN  
21-246-000-012.DGN  
21-246-000-013.DGN  
21-246-000-014.DGN  
21-246-000-015.DGN  
21-246-000-016.DGN  
21-246-000-017.DGN  
21-246-000-018.DGN  
21-246-000-019.DGN  
21-246-000-020.DGN  
21-246-000-021.DGN  
21-246-000-022.DGN  
21-246-000-023.DGN  
21-246-000-024.DGN  
21-246-000-025.DGN  
21-246-000-026.DGN  
21-246-000-027.DGN  
21-246-000-028.DGN  
21-246-000-029.DGN  
21-246-000-030.DGN  
21-246-000-031.DGN  
21-246-000-032.DGN  
21-246-000-033.DGN  
21-246-000-034.DGN  
21-246-000-035.DGN  
21-246-000-036.DGN  
21-246-000-037.DGN  
21-246-000-038.DGN  
21-246-000-039.DGN  
21-246-000-040.DGN  
21-246-000-041.DGN  
21-246-000-042.DGN  
21-246-000-043.DGN  
21-246-000-044.DGN  
21-246-000-045.DGN  
21-246-000-046.DGN  
21-246-000-047.DGN  
21-246-000-048.DGN  
21-246-000-049.DGN  
21-246-000-050.DGN  
21-246-000-051.DGN  
21-246-000-052.DGN  
21-246-000-053.DGN  
21-246-000-054.DGN  
21-246-000-055.DGN  
21-246-000-056.DGN  
21-246-000-057.DGN  
21-246-000-058.DGN  
21-246-000-059.DGN  
21-246-000-060.DGN  
21-246-000-061.DGN  
21-246-000-062.DGN  
21-246-000-063.DGN  
21-246-000-064.DGN  
21-246-000-065.DGN  
21-246-000-066.DGN  
21-246-000-067.DGN  
21-246-000-068.DGN  
21-246-000-069.DGN  
21-246-000-070.DGN  
21-246-000-071.DGN  
21-246-000-072.DGN  
21-246-000-073.DGN  
21-246-000-074.DGN  
21-246-000-075.DGN  
21-246-000-076.DGN  
21-246-000-077.DGN  
21-246-000-078.DGN  
21-246-000-079.DGN  
21-246-000-080.DGN  
21-246-000-081.DGN  
21-246-000-082.DGN  
21-246-000-083.DGN  
21-246-000-084.DGN  
21-246-000-085.DGN  
21-246-000-086.DGN  
21-246-000-087.DGN  
21-246-000-088.DGN  
21-246-000-089.DGN  
21-246-000-090.DGN  
21-246-000-091.DGN  
21-246-000-092.DGN  
21-246-000-093.DGN  
21-246-000-094.DGN  
21-246-000-095.DGN  
21-246-000-096.DGN  
21-246-000-097.DGN  
21-246-000-098.DGN  
21-246-000-099.DGN  
21-246-000-100.DGN

CANAVERAL HARBOR  
BREVARD COUNTY, FLORIDA  
**4Q PORT HYDRO EXAM SURVEY FY21**  
35, 39, 41, 43, 44 AND 46-FOOT PROJECT  
STA. 192+00 CUT - 2 THRU STA. 216+00 M.T.B.  
PLAN

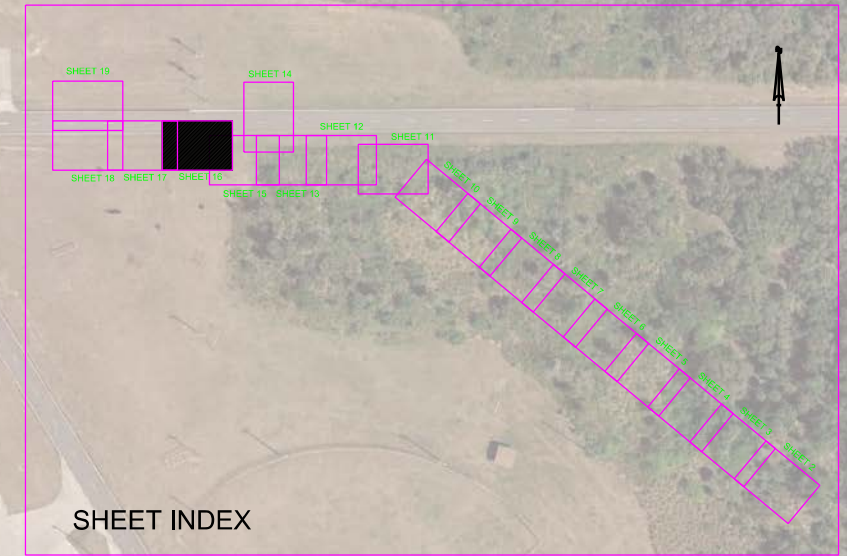
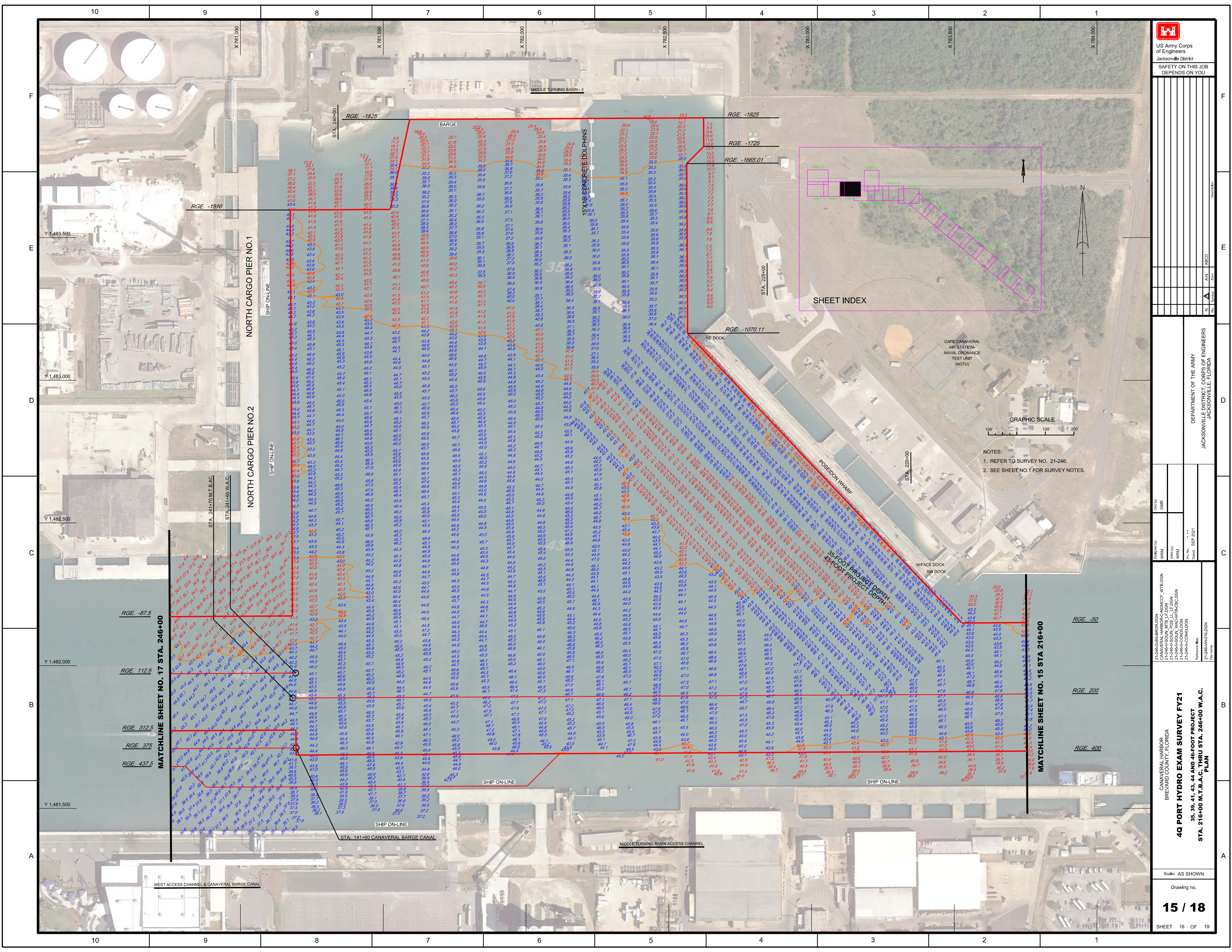

- NOTES:  
1. REFER TO SURVEY NO. 21-246.  
2. SEE SHEET NO. 1 FOR SURVEY NOTES.

MATCHLINE SHEET NO. 17 STA. 246+00  
RGE -87.5  
RGE 112.5  
RGE 312.5  
RGE 375  
RGE 437.5

MATCHLINE SHEET NO. 15 STA 216+00  
RGE -50  
RGE 200  
RGE 400

Zone	AN	ABCD
Scale	N	AS SHOWN
Sheet No.	15	18
Project Name	4Q PORT HYDRO EXAM SURVEY FY21	
Stationing	35, 39, 41, 43, 44 AND 46-FOOT PROJECT STA. 216+00 M.T.B.A.C. THRU STA. 246+00 W.A.C. PLAN	

DEPARTMENT OF THE ARMY  
JACKSONVILLE DISTRICT CORPS OF ENGINEERS  
JACKSONVILLE, FLORIDA

21-246-GS-BR/BLDGN  
CANAVERAL HARBOUR-ENG/CCF\_WYB/DGN  
21-246-A-SOUL\_POS\_LL\_LF/DGN  
21-246-A-SOUL\_WAC\_WYB-BC/DGN  
21-246-A-CON/BLDGN  
Date: SEP 2021

CANAVERAL HARBOR  
BREVARD COUNTY, FLORIDA  
4Q PORT HYDRO EXAM SURVEY FY21  
35, 39, 41, 43, 44 AND 46-FOOT PROJECT  
STA. 216+00 M.T.B.A.C. THRU STA. 246+00 W.A.C. PLAN

MAP LABEL	AIDS TO NAVIGATION	PLANE COORDINATES		LATITUDE	LONGITUDE
		X	Y		
G*15*	LT. BUOY-15 (09/21)	779,662	1,481,738	28°24'33.75"	80°36'56.99"
G*19*	LT. BUOY-19 (09/21)	778,147	1,481,693	28°24'33.35"	80°37'13.96"

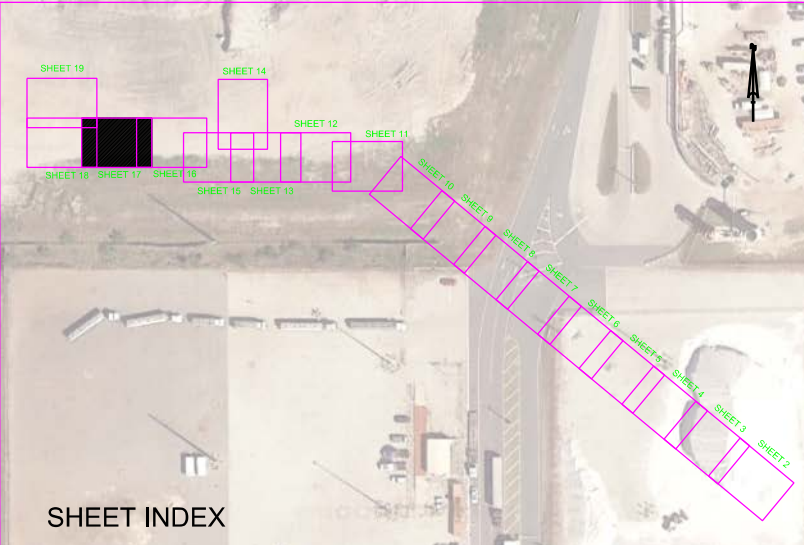

MATCHLINE SHEET NO. 18 STA. 276+00

MATCHLINE SHEET NO. 16 STA. 246+00

RGE. -87.5  
RGE. 112.5  
RGE. 312.5  
RGE. 375  
RGE. 400  
RGE. 437.5

RGE. -87.5  
RGE. 112.5  
RGE. 312.5  
RGE. 375  
RGE. 437.5



NOTES:  
1. REFER TO SURVEY NO. 21-246.  
2. SEE SHEET NO.1 FOR SURVEY NOTES.



No.	Symbol	Zone
N	▲	ABCD

DEPARTMENT OF THE ARMY  
JACKSONVILLE DISTRICT CORPS OF ENGINEERS  
JACKSONVILLE, FLORIDA

Checked by: GHR  
Designed by: WRM  
Drawn by: WRM  
File No.: 21-246-CON-1310  
Date: SEP 2021

21-246-CON-1310  
CANAVERAL HARBOR/CON-1310  
21-246-CON-1310  
21-246-CON-1310

CANAVERAL HARBOR  
BREVARD COUNTY, FLORIDA  
4Q PORT HYDRO EXAM SURVEY FY21  
35, 39, 41, 43, 44 AND 46-FOOT PROJECT  
STA. 246+00 W.A.C. THRU STA. 276+00 W.T.B.  
PLAN

Scale: AS SHOWN  
Drawing no.

16 / 18  
SHEET 17 OF 19



MAP LABEL	AIDS TO NAVIGATION	PLANE COORDINATES		LATITUDE	LONGITUDE
		X	Y		
R2	DBN-2 (09/21)	776,588	1,481,775	28°24'34.21"	80°37'31.42"

MATCH LINE SHEET NO. 19 RGE. -1700

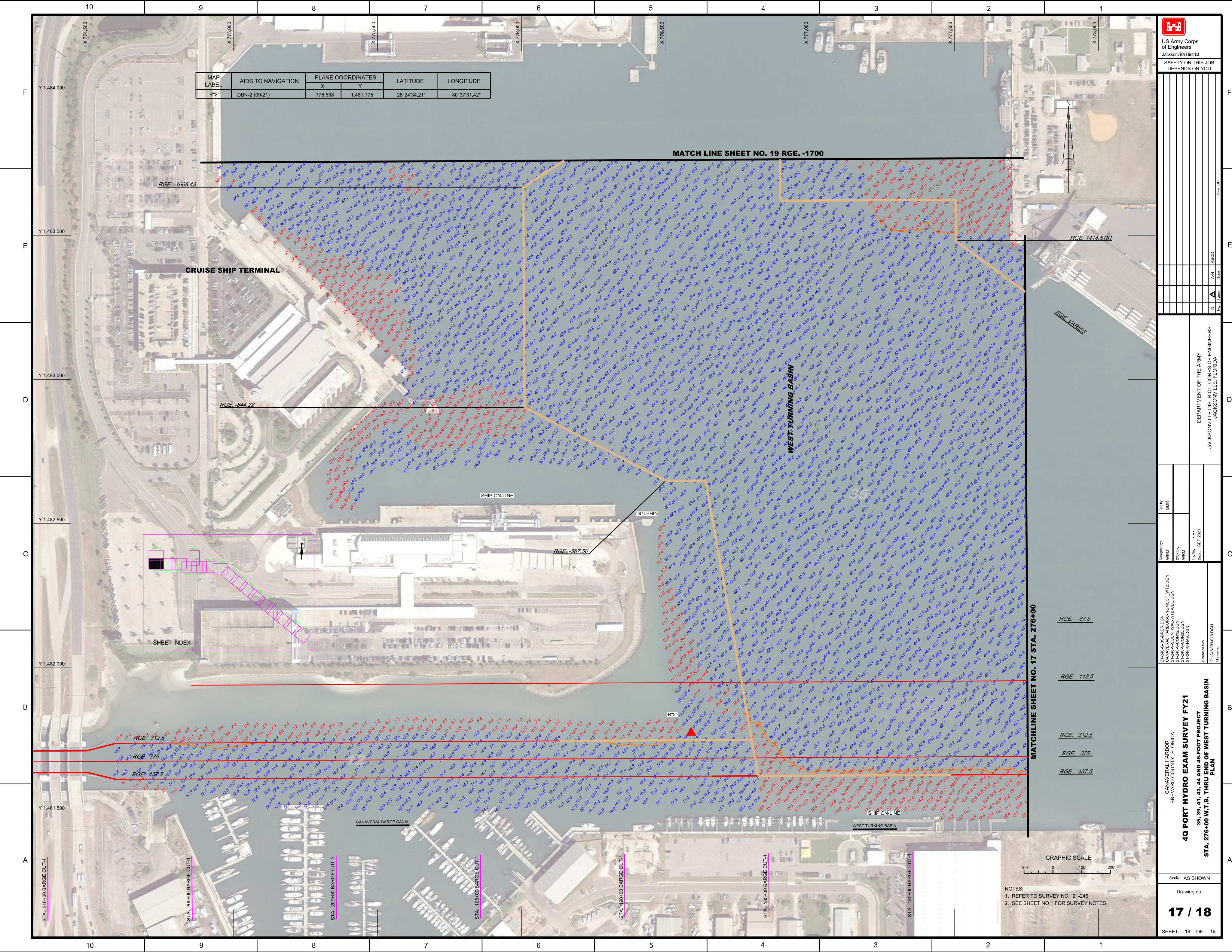

CRUISE SHIP TERMINAL

SHIP-ON-LINE

DOLPHIN

WEST TURNING BASIN

SHEET INDEX

MATCHLINE SHEET NO. 17 STA. 276+00

GRAPHIC SCALE  
100' 0 100' 200'

NOTES:  
1. REFER TO SURVEY NO. 21-246.  
2. SEE SHEET NO.1 FOR SURVEY NOTES.

<p>21-246-048-BRDLDGN CANAVERAL MARSH-CRNGMCCF_WTB.DGN 21-246-048-CON12.DGN 21-246-048-CON15.DGN 21-246-048-HMV.DGN</p>	<p>21-246-048-BRDLDGN 21-246-048-CON12.DGN 21-246-048-HMV.DGN</p>	<p>21-246-048-CON12.DGN 21-246-048-CON15.DGN 21-246-048-HMV.DGN</p>	<p>21-246-048-CON12.DGN 21-246-048-CON15.DGN 21-246-048-HMV.DGN</p>
<p>Checked by: GHR</p>	<p>Designed by: WRM</p>	<p>Drawn by: WRM</p>	<p>Scale: AS SHOWN</p>
<p>Department of the Army Jacksonville District, Corps of Engineers Jacksonville, Florida</p>	<p>4Q PORT HYDRO EXAM SURVEY FY21 35, 39, 41, 43, 44 AND 46-FOOT PROJECT STA. 276+00 W.T.B. THRU END OF WEST TURNING BASIN PLAN</p>	<p>Drawing no. <b>17 / 18</b></p>	<p>SHEET 18 OF 19</p>

